

ENDO-MATE DT Standard Pack



ENDO-MATE DT Standard Pack

MODEL	ORDER CODE
ENDO-MATE DT (120V)	Y141-120
ENDO-MATE DT (230V)	Y141-121

- Control unit • Motor and cord
- MP-F20R head (20:1)
- Handpiece stand • AC adaptor

ENDO-MATE DT Standard Pack Without Head

MODEL	ORDER CODE
ENDO-MATE DT W/O (120V)	Y141-123
ENDO-MATE DT W/O (230V)	Y141-124

- Control unit • Motor and cord
- Handpiece stand • AC adaptor
- * ENDO-MATE DT pack without Head

Specifications

- Power supply: AC120V or 230V 50/60 Hz and Battery pack
- Number of Program: 9 • Max Torque: 7Ncm (when using 20:1 head)
- Speed range: 100~13,000min⁻¹ (with 20:1,4:1,1:1 geared heads)
- Charge/Continuous use: 5h/2h (depending on workload)
- Dimensions: W92xD148xH124mm • Weight: Unit 456g / Motor handpiece & cord 92g

[Push type]

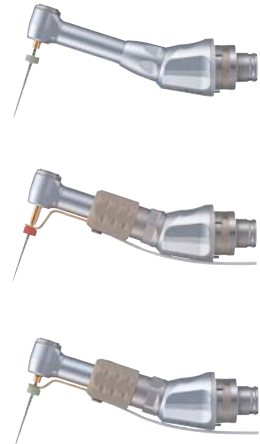

MODEL	ORDER CODE
○ MP-F20R	Y110-044
● MP-F4R	Y110-047

- Miniature Head • 360° Rotation
- 20:1 / 4:1 Reduction • For Ni-Ti files (ø2.35)

MODEL	ORDER CODE
○ MPA-F20R	Y110-045
● MPA-F4R	Y110-051

- Miniature Head • 360° Rotation
- 20:1 / 4:1 Reduction • For Ni-Ti files (ø2.35)
- Connection for Apex locator

MODEL	ORDER CODE
○ MPAS-F20R	Y110-046
● MPAS-F4R	Y110-052

- Miniature Head • 360° Rotation
- 20:1 / 4:1 Reduction • For Ni-Ti files (ø2.35)
- Connection for Apex locator

[Latch type]

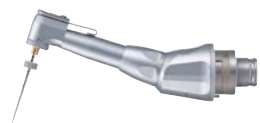

MODEL	ORDER CODE
○ NML-F20R	Y110-053
● NML-F4R	Y110-018

- Miniature Head • 360° Rotation
- 20:1 / 4:1 Reduction • For Ni-Ti files (ø2.35)

The icons shown beside each of the models indicate the reduction gear ratio of the head. All heads pictured in this brochure are the 20:1 model type.
White = 20:1 Reduction
Green = 4:1 Reduction



MODEL	PRODUCTS	ORDER CODE
ENDO-MATE DT Unit		U421-002
Motor & Cord		E275
Adaptor (120V) Adaptor (230V)		U479-001 U480-001
Handpiece Stand		Z095-206
FC-15 Foot Control		Z248

Apex Locator Capability

MPA and MPAS heads are equipped with built-in probe ring which enables to use the Apex locator with the ENDO-MATE DT system. By combining an Apex Locator with NSK ENDO-MATE DT, clinicians will be able to perform more accurate root canal preparations. All heads are autoclavable up to 135°C.

2 types of file holders

2 types of file holders are available relevant to the shank length of the file selected.

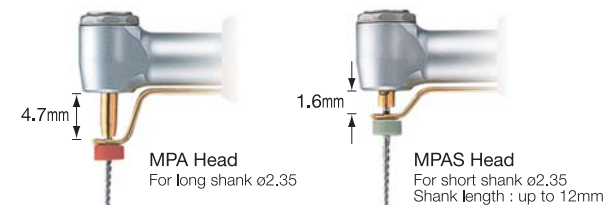

Attach the Apex Locator Monitor by moving it forward to contact the file. Release by moving away from the file.

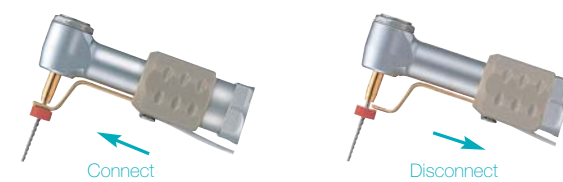

NSK www.nsk-inc.com

NAKANISHI INC
700 Shimohinata
Kanuma, Tochigi
322-8666, Japan
TEL:+81 (0)289-64-3380
FAX:+81 (0)289-62-5636

NSK TOKYO OFFICE
6F MY Building
Ueno 1-13-3, Taito-ku
Tokyo 110-0005, Japan
TEL:+81 (0)3-3835-2892
FAX:+81 (0)3-3835-2856

NSK EUROPE GmbH EC REP
Westerbachstraße 58
D-60489, Frankfurt,
Germany
TEL:+49 (0)69 74 22 99 0
FAX:+49 (0)69 74 22 99 29

NSK FRANCE SAS
19 avenue de Villiers
75017 Paris,
France
TEL:+33 01 56 79 59 80
FAX:+33 01 56 79 59 81

NSK MIDDLE EAST
Dubai Airport Free Zone,
Room 2W-310,
3F West Wing, Dubai, UAE
TEL:+971-4-299-6644
FAX:+971-4-299-6664

Specifications are subject to change without notice.

REF:PR-D270E Ver.4 06.09.05.Y

ENDO-MATE DT FROM NSK ENDO MICROMOTOR WITH TORQUE CONTROL

NSK
ENDO-MATE DT

smart & portable



Powerful Partners®

ENDO-MATE DT

ENDO-MATE DT has been developed for use with all brands of Ni-Ti files. The preprogramming function allows highly efficient treatments using different file manufacturer's procedures. The control unit has been designed to be lightweight and compact. It is fitted with a rechargeable battery providing high mobility. The lightweight and slim handpiece allows high performance.



Features of ENDO-MATE DT

1. Fits all popular brands of Ni-Ti files
2. Torque control, with an auto-reverse function
3. Desktop type in compact sized unit
4. Wide screen provides high visibility
5. Flat control panel allows simple and user friendly operation
6. 2 way power source (AC cord / rechargeable battery pack)
7. Lightweight, smart and comfortable handpiece
8. Handy on/off switch

Lightweight, smart and comfortable handpiece.

6 position adjustable head system

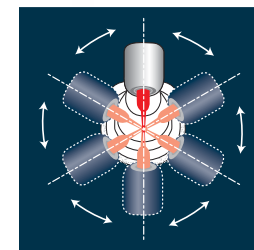

The head direction can be set in 6 positions. The most convenient position can be selected for any clinical site and this feature also gives the user the most comfortable access to the on / off switch according to preference.

Handy ON/OFF switch

Functions are :

- A: Push and release - the micromotor will rotate continuously until the button is pushed again.
- B: Push and do not release the button - the micromotor will rotate continuously until the button is released.

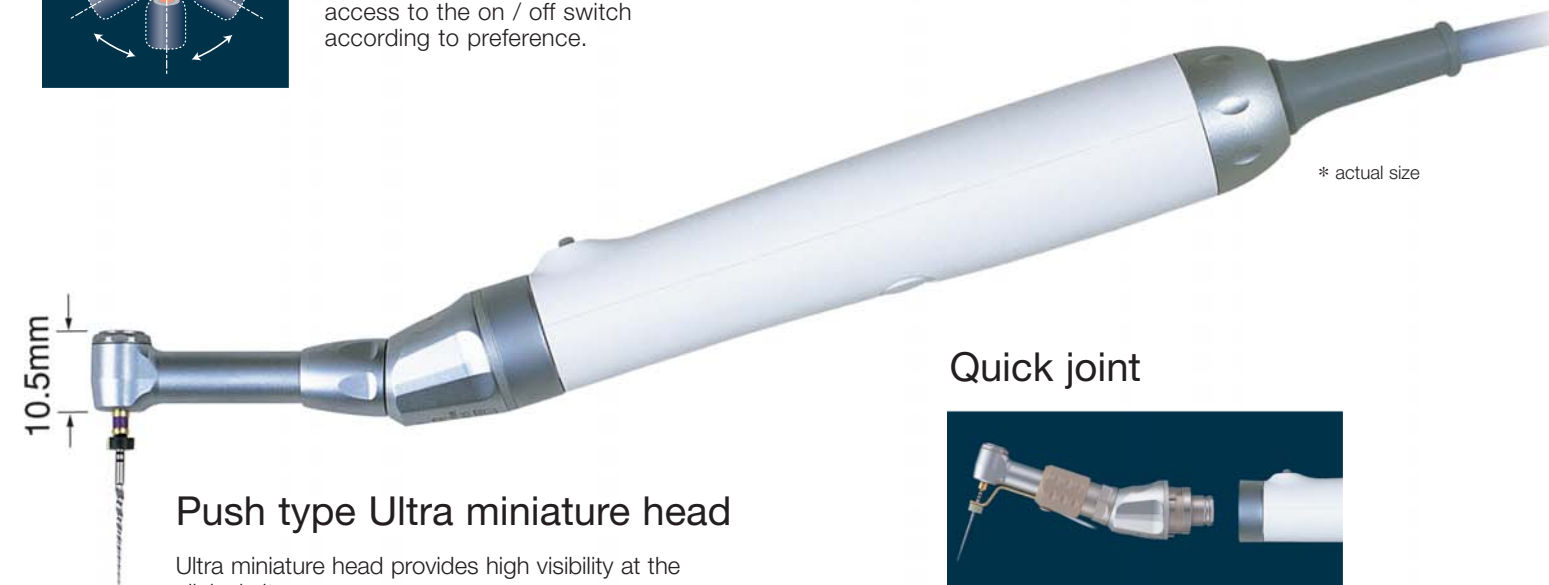

Push type Ultra miniature head

Ultra miniature head provides high visibility at the clinical site.

Quick joint



Quick joint system allows for easy head exchange. All heads are autoclavable up to 135°C.

Fits all popular brands of Ni-Ti files.

Up to 9 settings (speed and torque etc) can be programmed simply by pushing the memory function button. It's easy to switch between each preset program allowing work with all popular Ni-Ti file manufacturer's required procedures.

Gear	Head Speed(min⁻¹)
20:1	100-650
16:1	125-800
10:1	200-1,300
4:1	500-3,200
1:1	2,000-13,000

2 way power source

ENDO-MATE DT has been designed to work with a rechargeable battery for portable use or can be powered using the AC adaptor supplied.

Flat control panel allows simple user friendly operation

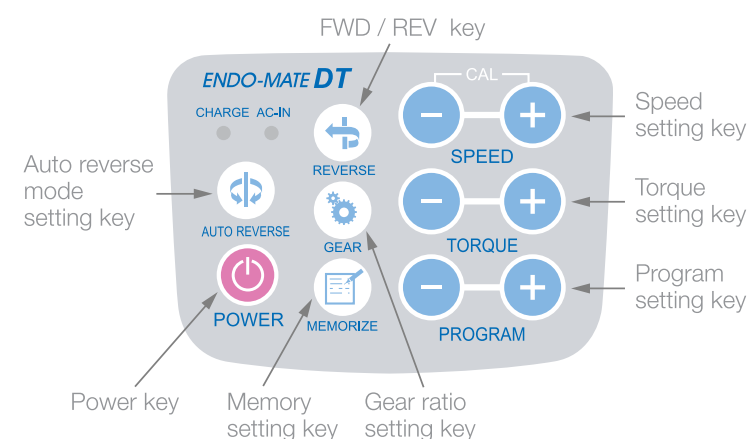

Wide screen provides high visibility

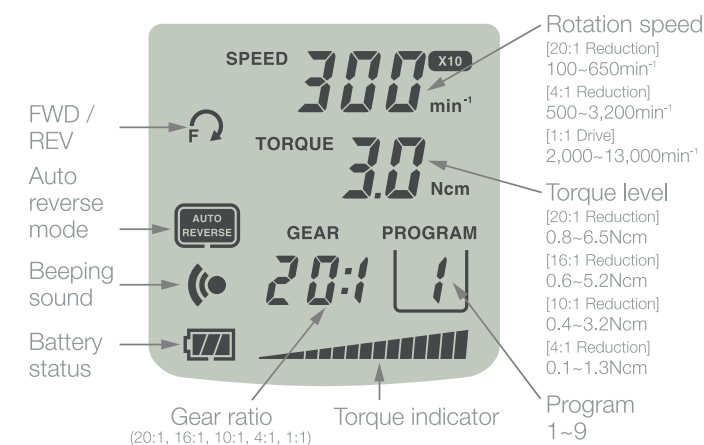

Auto reverse function

The auto reverse function activates when the preset torque level has been exceeded and can be set to operate in the following Modes:

- [Continue automatically]**
The motor reverts to forward rotation after auto reverse has freed the file.
- [Stop automatically]**
The motor stops after auto reverse has freed the file.
- Alternatively, the auto reverse function can be deactivated.

2 way ON/OFF switch



Motor ON/OFF operation is selected with handy switch located on the handpiece body or foot controller according to user's choice. (Foot controller is optional).

Other functions

- Beeping sound notifies user when preset torque limit has been exceeded.
- Auto power OFF function (after inactive for 10 mins).
- Battery status is shown on the screen.